

## FUNCTION ROOM CAPACITIES:

OVER 190,000 SQ. FT. OF INDOOR AND OUTDOOR MEETING SPACE

Function Space	Total Square Footage	Room Dimensions	Ceiling Height	Theater	Classroom	Conference	U shape	72" Crescent Rounds of 8	60" Rounds of 10	72" Rounds of 12	Reception	Exhibits
Salon de Fiesta	17176	113'x152'	17'	1907	1140	n/a	n/a	906	1130	1548	1718	96
Fiesta 1, 2, 3, 4, 11, 12, 13 or 14	850	29'x27'	17'	96	60	28	28	40	60	60	78	n/a
Fiesta 5, 7, 9, 6, 8 or 10	1770	59'x30'	17'	196	120	48	54	112	90	120	170	9
Fiesta 1, 2 Fiesta 3, 4 Fiesta 11, 12 Fiesta 13, 14	1770	59'x30'	17'	196	120	48	54	112	90	120	170	16
Fiesta 1, 2, 5 Fiesta 3, 4, 6 Fiesta 9, 11, 12 Fiesta 10, 13, 14	3186	59'x54'	17'	354	220	n/a	64	184	240	300	400	16
Fiesta 1, 2, 5, 7 Fiesta 3, 4, 6, 8 Fiesta 7, 9, 11, 12 Fiesta 8, 10, 13, 14	4806	89'x54'	17'	534	332	n/a	94	248	432	420	600	24
Fiesta 1, 2, 5, 7, 9 Fiesta 3, 4, 6, 8, 10 Fiesta 5, 7, 9, 11, 12 Fiesta 6, 8, 10, 13, 14	6372	118'x54'	17'	708	462	n/a	n/a	376	470	600	800	32
Fiesta 1, 2, 5, 7, 9, 11, 12 Fiesta 3, 4, 6, 8, 10, 13, 14	8588	147'x54'	17'	954	570	n/a	n/a	476	600	780	1000	41
Fiesta 1-4 Fiesta 5, 6 Fiesta 7, 8 Fiesta 9, 10 Fiesta 11-14	3400	29'x113'	17'	377	226	n/a	n/a	176	220	276	400	16
Fiesta 1-6	6667	59'x113'	17'	740	460	n/a	n/a	376	470	588	800	33
Fiesta 1-8	10057	89'x113'	17'	1117	694	n/a	n/a	552	690	948	1000	50
Fiesta 1-10	13447	119'x113'	17'	1827	928	n/a	n/a	728	910	1200	1345	67
Fiesta Veranda	3220	23'x140'	n/a	n/a	n/a	n/a	n/a	n/a	n/a	n/a	320	n/a
Diego or Las Brisas	3,859	68'x59'	-	-	-	-	-	-	-	-	-	-
Diego or Las Brisas 1	1,419	25'x59'	-	-	-	-	-	-	-	-	-	-
Diego or Las Brisas 2	1,321	24'x59'	-	-	-	-	-	-	-	-	-	-
Diego or Las Brisas 3	1,119	20'x59'	-	-	-	-	-	-	-	-	-	-

## FUNCTION ROOM CAPACITIES:

OVER 190,000 SQ. FT. OF INDOOR AND OUTDOOR MEETING SPACE

Function Space	Total Square Footage	Room Dimensions	Ceiling Height	Theater	Classroom	Conference	U shape	72" Crescent Rounds of 8	60" Rounds of 10	72" Rounds of 12	Reception	Exhibits
Salon de Flores	16116	158'x102'	17'	1790	1074	n/a	n/a	1152	1540	1728	1612	90
Flores 1, 2, 3, 6, 7 or 8	1326	34'x39'	17'	147	86	36	41	72	100	108	80	n/a
Flores 1 & 2 or 6 & 7	2652	68'x39'	17'	286	180	60	74	144	220	216	200	n/a
Flores 1-3 or 6-8	3978	102'x39'	17'	442	263	n/a	n/a	224	350	336	350	20
Flores 1-4 or 5-8	8058	102'x78'	17'	898	546	n/a	n/a	488	770	732	700	40
Flores 1-5 or 4-8	12138	102'x118'	17'	1348	809	n/a	n/a	712	1120	1068	1200	60
Flores 2 & 3 or 7 & 8	2652	68'x39'	17'	286	180	60	74	144	220	216	200	n/a
Flores 4 or 5	3978	102'x39'	17'	442	263	n/a	n/a	224	350	336	350	20
Flores 4 & 5	8058	102'x79'	17'	898	546	n/a	n/a	488	770	732	700	40
Flores Foyer	4325	25'x173'	17'	n/a	n/a	n/a	n/a	n/a	n/a	n/a	433	20
Flores Veranda	3400	17'x200'	n/a	n/a	n/a	n/a	n/a	n/a	360	432	500	n/a
Flores A	238	14'x17'	9'	25	8	10	12		10			
Flores B or C	396	22'x18'	9'	40	24	16	20					
Frank Capra Ballroom	5952		10'									
Capra A, B or C	1344	32'x42'	10'	144	87	36	41	72	90	72	70	n/a
Capra D or E	960	30'x32'	10'	107	65	24	30	40	50	48	60	n/a
Capra A & B	2688	64'x42'	10'	300	175	65	70	112	140	130	120	n/a
Capra A, B & C	4032	96'x42'	10'	448	262	n/a	n/a	176	220	252	300	15
Capra A, B, D, & E	4608	64'x72'	10'	512	300	n/a	n/a	n/a	280	324	380	21
Capra A & E	2304	32'x72'	10'	256	150	50	55	96	150	120	130	n/a
Capra B & D	2304	32'x72'	10'	256	150	50	55	96	150	120	130	n/a
Studios	1278	26'x53'	10'	170	75	35	42	64	80	96	200	6
Grgich Room	420	14'x30'	8'	n/a	n/a	22	n/a	n/a	n/a	n/a	n/a	n/a
Grgich Patio	345	15'x23'	n/a	n/a	n/a	n/a	n/a	n/a	n/a	n/a	n/a	n/a
Outdoor Venues												
Main Lawn	3515	95'x37'	n/a	450	n/a	n/a	n/a	n/a	280	300	400	n/a
Hotel Waterfall	1980	55'x36'	n/a	220	n/a	n/a	n/a	n/a	400	480	1000	n/a
All Grass Area	25000	129'x124'	n/a	n/a	n/a	n/a	n/a	n/a	1360	1356	2500	n/a
Plunge	19200	120'x160'	n/a	n/a	n/a	n/a	n/a	n/a	600	720	800	n/a
Main Pool	19600	196'x100'	n/a	n/a	n/a	n/a	n/a	n/a	620	564	800	n/a
Tennis Courtside	57000	196'x300'	n/a	1032	n/a	n/a	n/a	n/a	600	n/a	1000	n/a
La Casa Courtyard	1872	39'x48'	n/a	140	n/a	n/a	n/a	n/a	90	108	150	n/a
La Casa Patio	7350	70'x105'	n/a	510	n/a	n/a	n/a	n/a	650	780	600	37
San Vicente Courtyard	1681	41'x41'	n/a	n/a	n/a	n/a	n/a	n/a	80	96	125	n/a

## MEETING FACILITIES

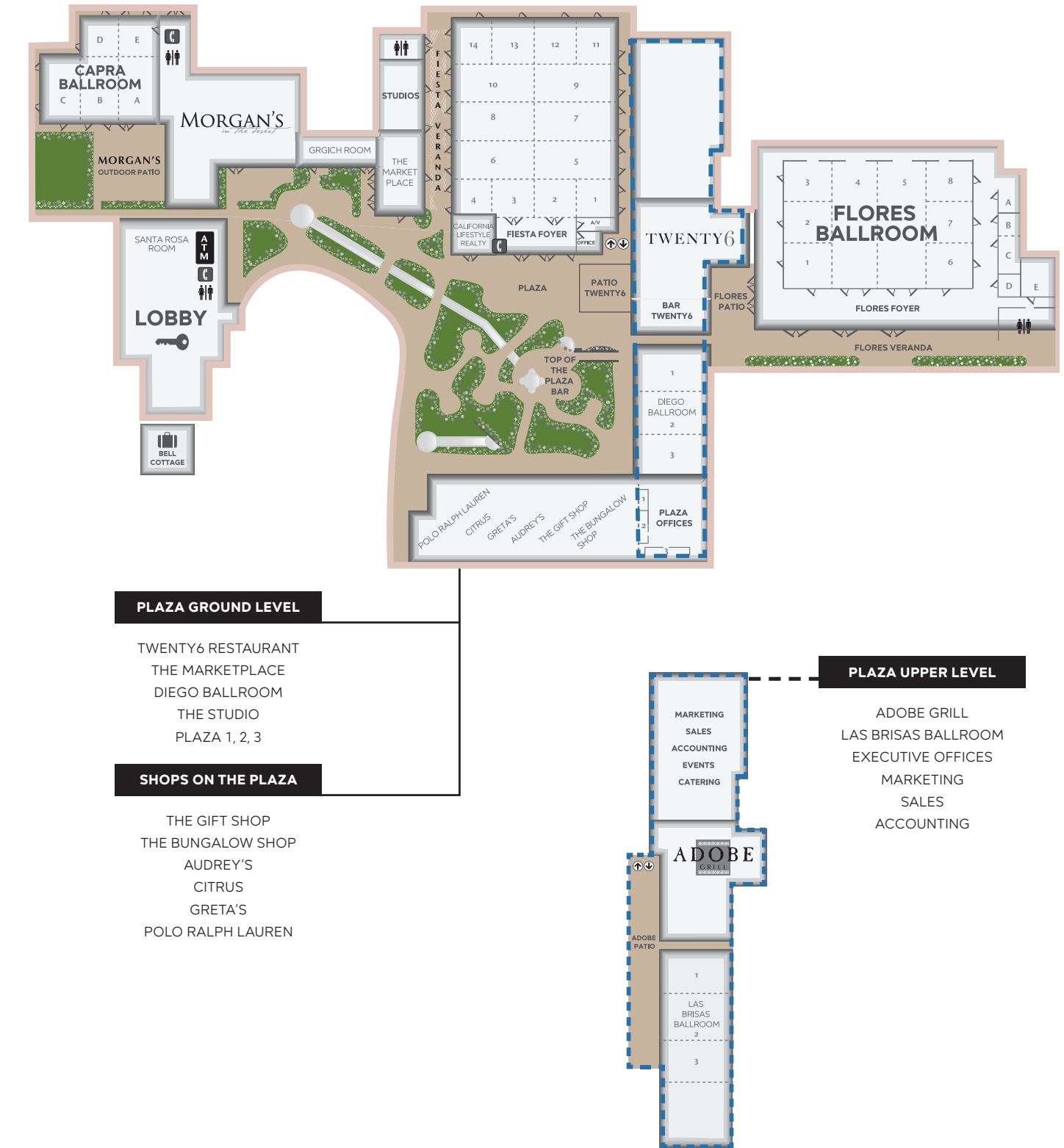

Please note that figures represent maximum set without staging or audio/visual. Ceilings are measured at their lowest point. Classroom seating is 3 people per 6 foot table.